



SIGNALLING COLUMN SINGLE-FLASH LIGHT ELEMENT  
YELLOW,  
230V AC

General technical details:		
product brand name		SIRIUS
Product component / fluorescent materials		Yes
Design of the optical signal		flash light
Type of voltage		AC
<ul style="list-style-type: none"> <li>of operating voltage</li> </ul>		
Operating voltage		
<ul style="list-style-type: none"> <li>1 / at 50 Hz / for AC / rated value</li> </ul>	V	230
<ul style="list-style-type: none"> <li>1 / at 60 Hz / for AC / rated value</li> </ul>	V	230
Reference code		
<ul style="list-style-type: none"> <li>according to DIN EN 61346-2</li> </ul>		P

Mechanical design:		
Mounting type		Bayonet
External diameter / of the signal column element	mm	70

Lamp:		
Nature of fluorescent material		LED

Ambient conditions:		
Ambient temperature		

• during operating	°C	-20 ... +50
<b>Protection class IP</b>		IP65
<b>Height</b>	mm	65.5
<b>Width</b>	mm	70

#### Certificates/approvals:

General Product Approval	EMC	Declaration of Conformity	Shipping Approval
	 UL	 C-TICK	 EG-Konf.
			 DNV

#### Further information:

##### Information- and Downloadcenter (Catalogs, Brochures,...)

<http://www.siemens.com/industrial-controls/catalogs>

##### Industry Mall (Online ordering system)

<http://www.siemens.com/industrial-controls/mall>

##### Cax online generator:

<http://www.siemens.com/cax>

##### Service&Support (Manuals, Certificates, Characteristics, FAQs,...)

<http://support.automation.siemens.com/WW/view/en/8WD4450-0CD/all>

##### Image database (product images, 2D dimension drawings, 3D models, device circuit diagrams, ...)

[http://www.automation.siemens.com/bilddb/cax\\_en.aspx?mlfb=8WD4450-0CD](http://www.automation.siemens.com/bilddb/cax_en.aspx?mlfb=8WD4450-0CD)

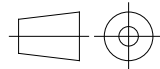
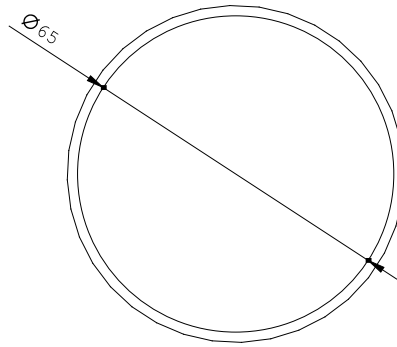
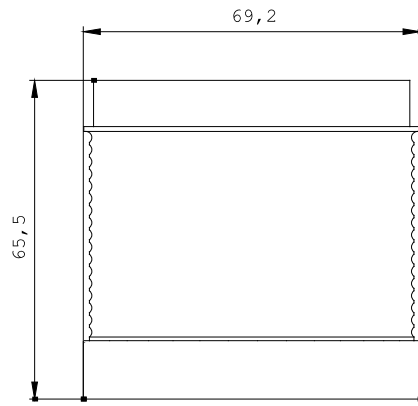

\W9.4444;  
\W6.8333; 8WD44...-

last change:

Jun 16, 2014